

# Harbour Health Assisted Living

Osprey • Studio

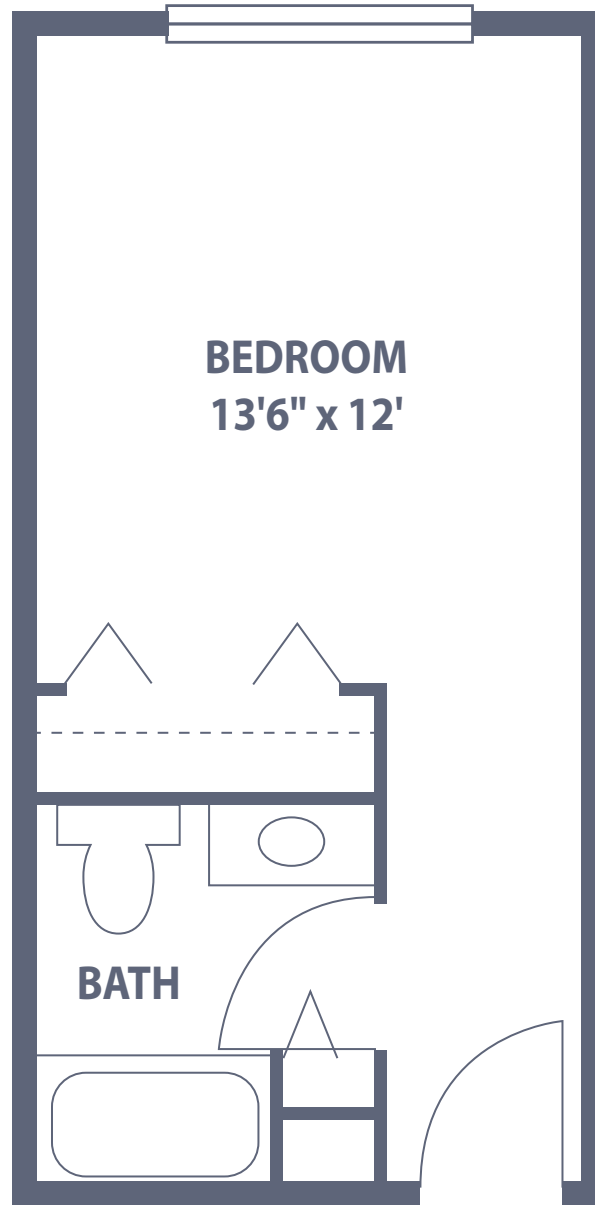

Dimensions are approximate.  
Floor plans may vary.

Harbour Health Assisted Living and Memory Care  
23013 Westchester Blvd. • Port Charlotte, FL 33980  
941-625-1100 • [SouthPortSeniorLiving.com](http://SouthPortSeniorLiving.com)

Managed by  Life Care Services® 

# Harbour Health Assisted Living

Naples • Suite

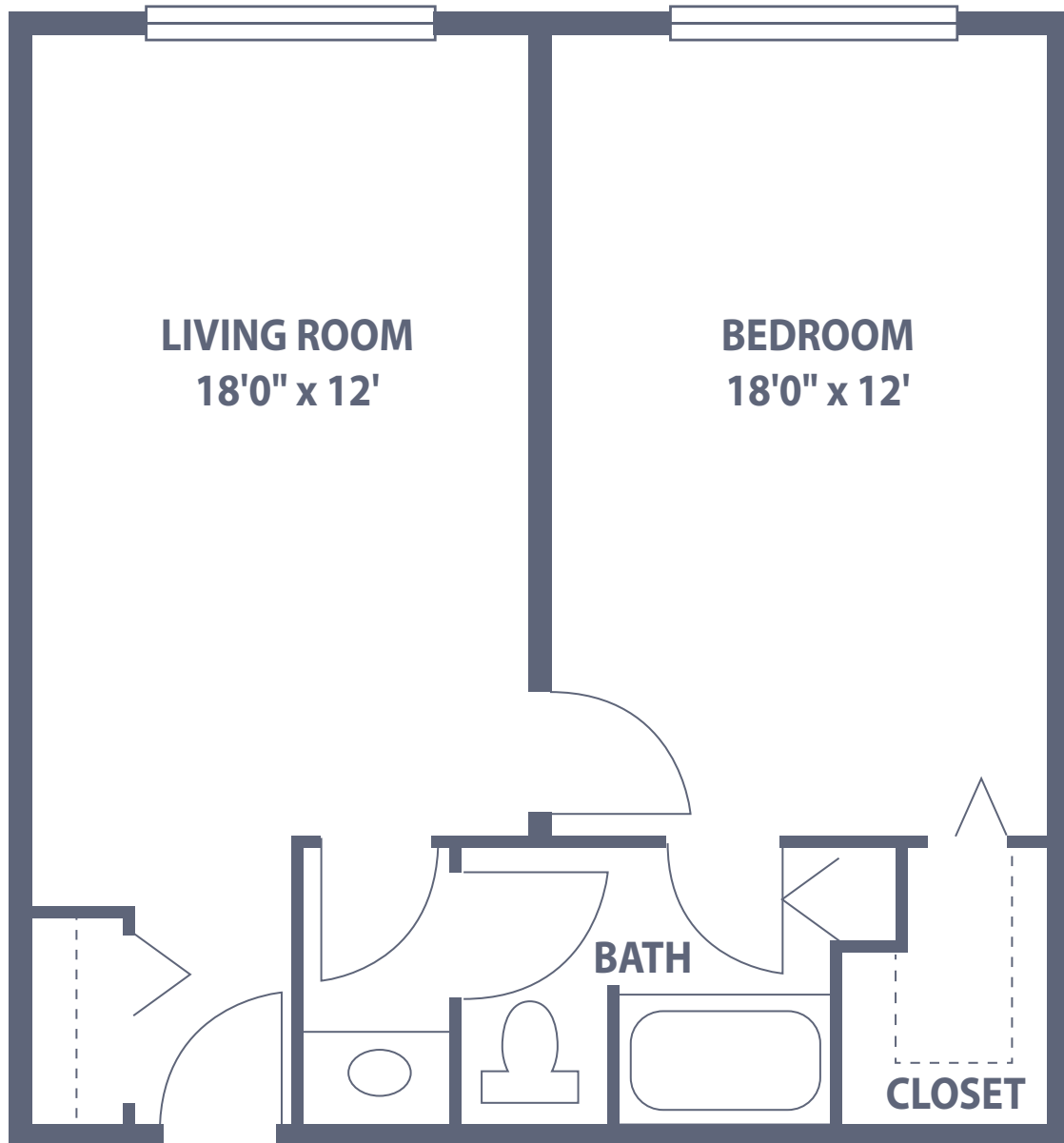

Dimensions are approximate.  
Floor plans may vary.

Harbour Health Assisted Living and Memory Care  
23013 Westchester Blvd. • Port Charlotte, FL 33980  
941-625-1100 • [SouthPortSeniorLiving.com](http://SouthPortSeniorLiving.com)

Managed by  Life Care Services®

 EQUAL HOUSING OPPORTUNITY

# Harbour Health Assisted Living

Sarasota • Suite

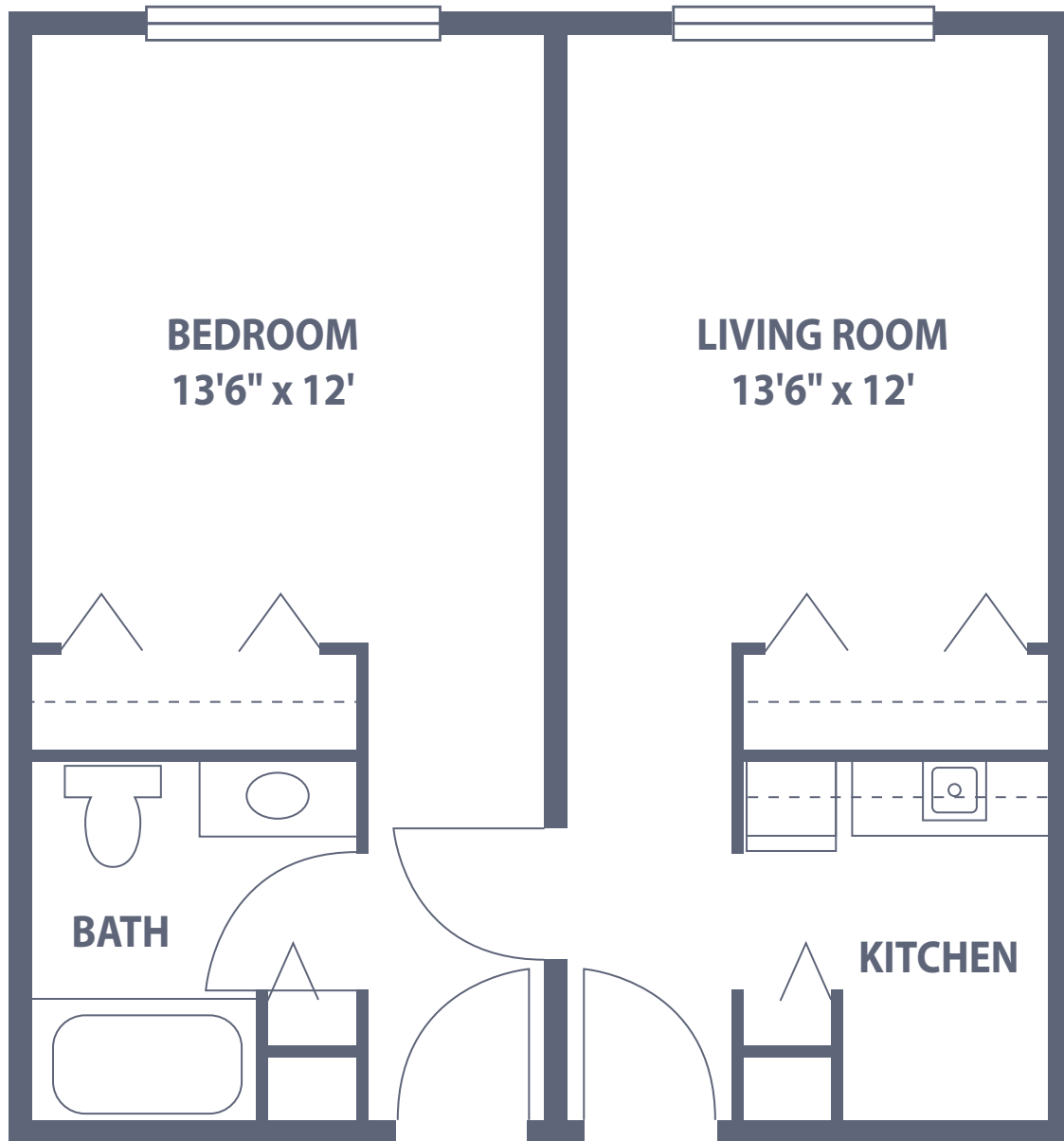

Dimensions are approximate.  
Floor plans may vary.

Harbour Health Assisted Living and Memory Care  
23013 Westchester Blvd. • Port Charlotte, FL 33980  
941-625-1100 • [SouthPortSeniorLiving.com](http://SouthPortSeniorLiving.com)

Managed by  Life Care Services®

 EQUAL HOUSING OPPORTUNITY